

Toyota Celica 2000- 70401

This Dash Mount is designed for:

Toyota Celica 2000- 2 x Airbag

Location:

Right side heater controls

Tools Required:

Phillips screwdriver



Monteringsanvisning

Steg 1: Panelet rundt gearspaken er klipset fast og dette løfter du rett opp. Trekk det så litt tilbake.

Steg 2: I framkant av gearspaken finner du 2 stjerne-skrur du skrur ut. Trekk så panelet ut ca 15mm i nedre kant.

Steg 3: Plasser Dash Mountens arm inn bak panelet slik at styretappen og hullet passer overens med de 2 hullene i Dash Mounten.

Steg 4: Sett inn skruer ,trekk til og sett gearpanelet på plass.

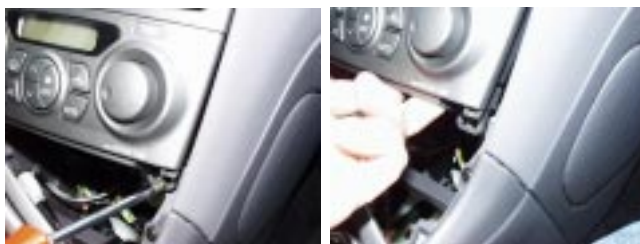

Mounting Instruction

Step 1: The panel surrounding the gearshift is clipped on, and you pull it straight up. Move it as far back as possible.

Step 2: In front of the gearshift you will find 2 screws that you remove. Lift the consolepanel gently out some 15mm.

Step 3: Locate the Dash Mount arm in behind the panel, so that the screw and locatingtab aligns with the 2 holes in the Dash Mount.

Step 4: Insert the screws , tighten well and reinstall the gearshift panel.



Correct direction of the rose pattern.



Do not use force when working with plastic components. Use extreme care not to scratch the interior of the vehicle. MTU may not be held liable for any damage to a vehicle connected to the installation.



Dato / Date: 15.10.1999